

| REVISION |         |                                    |
|----------|---------|------------------------------------|
| REV      | DATE    | DESCRIPTION                        |
| A        | 6/25/18 | 519469GCP - RELEASE PER EM3026 MRY |

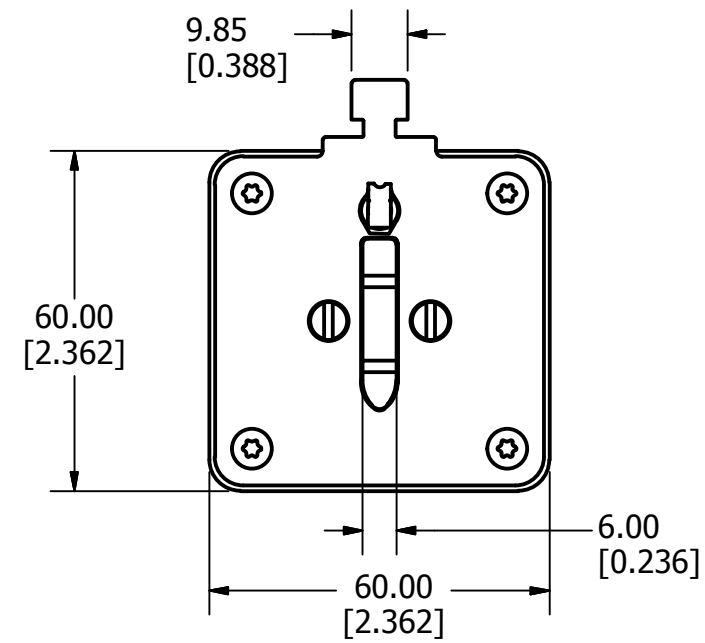
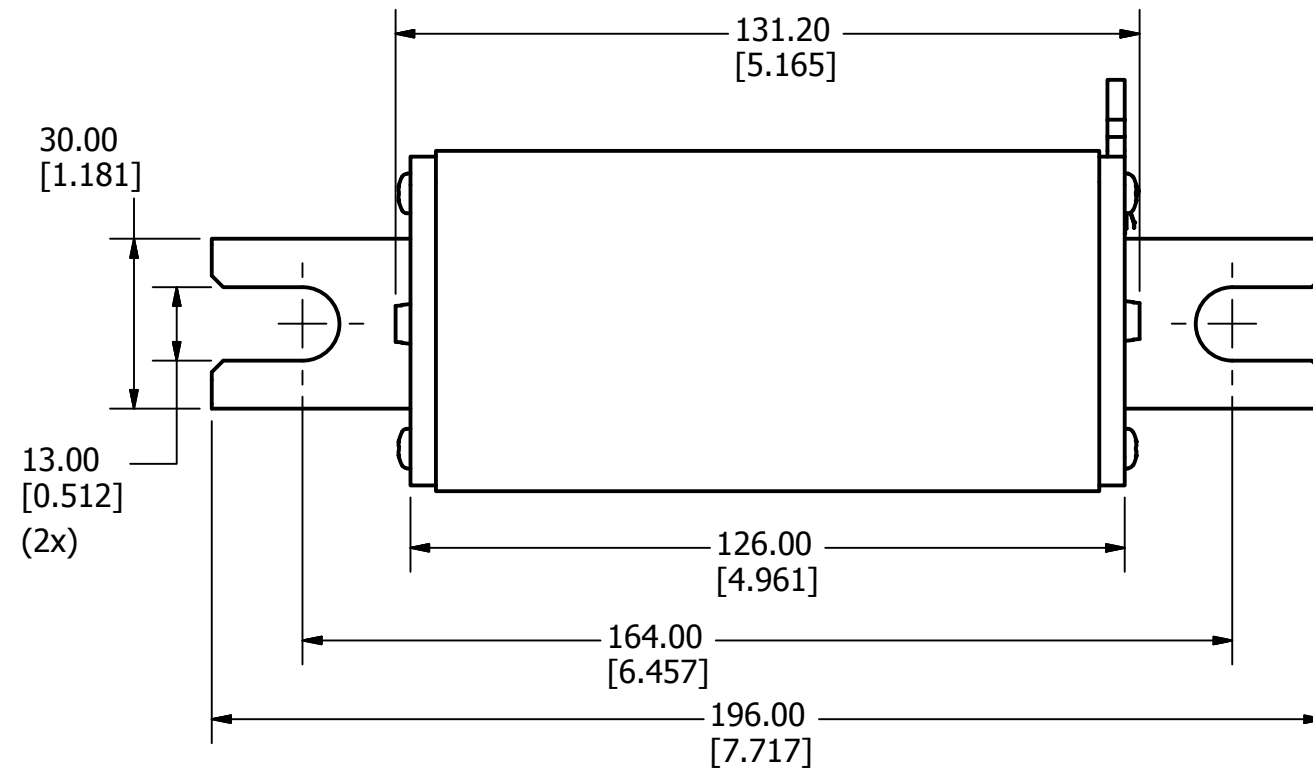

|     |  |
|-----|--|
| ●   | DENOTES CRITICAL CHARACTERISTICS.  |
| CPK | DENOTES CPK DIMENSIONS, -MINIMUM CPK VALUE   |
| ⊳   | DENOTES A CHARACTERISTIC THAT PROVIDES AN INDICATION OF PROCESS PERFORMANCE. PROCEDURE FOR MEASUREMENT AND TRACKING TO BE DEFINED IN LITTELFUSE INSPECTION INSTRUCTIONS. |
| CP  | DENOTES CP DIMENSIONS, -MINIMUM CP VALUE MUST BE WITHIN THE DIMENSIONAL LIMITATIONS SHOWN ON DRAWING AND INITIALLY LOCATED TO ALLOW FOR MAXIMUM TOOL LIFE.               |

**B**

|           |                |           |                            |
|-----------|----------------|-----------|----------------------------|
| MATL SPEC |                | FINISH    |                            |
| DRW MYORK | DATE 4/18/2018 | SCALE NTS | FINISH GOOD WT GRAMS/PIECE |

UNLESS OTHERWISE SPECIFIED, DIMENSIONS ARE IN MILLIMETERS, DIMENSIONS IN BRACKETS [ ] ARE INCHES DIMENSIONING AND DO NOT INCLUDE PLATING. TOLERANCING TO BE INTERPRETED IN ACCORDANCE WITH ANSI Y14.5M-1994

|                      |  |
|----------------------|--|
| 3RD ANGLE PROJECTION |  |
|----------------------|--|

**TITLE**  
1500VDC SIZE 2XL W/ U-BLADE PHOTOVOLTAIC FUSE W/ MICROSWITCH INTERFACE OUTLINE

|  |               |                              |              |
|--|---------------|------------------------------|--------------|
| <b>Littelfuse</b><br>CHICAGO, ILLINOIS 60631 | REVISION<br>A | DRWG NO.<br>OL-SPNH.X2XLDEMS | SHEET 1 OF 1 |
|--|---------------|------------------------------|--------------|